

# W&C SP ORDERING GUIDE

This ORDERING GUIDE is intended to assist you in the selection of W&C Single Point Series for Trailer.

For comprehensive information on other available W&C models, options and pricing, contact W&C CUSTOMER SERVICE at 800.445.0736 (US and Canada) or wc-customerservice@wcsuspensions-intl.com. Your W&C Customer Service Representative can help you complete this form.

<b>COMPANY:</b>		<b>NAME:</b>	
<b>EMAIL:</b>		<b>TELEPHONE / FAX:</b>	

**WARNING!** FAILURE TO PROVIDE **ALL** OF THE INFORMATION REQUESTED IN THIS FORM WILL PREVENT W&C FROM PROVIDING YOU WITH A CONFIGURED PART AND PRICE QUOTE. EACH STEP IN THIS FORM REQUIRES YOUR INPUT!

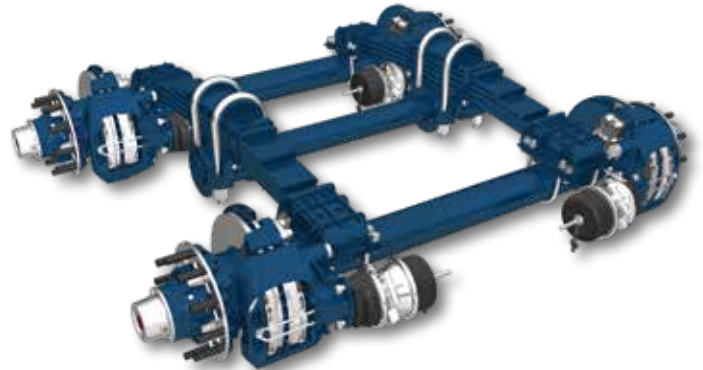
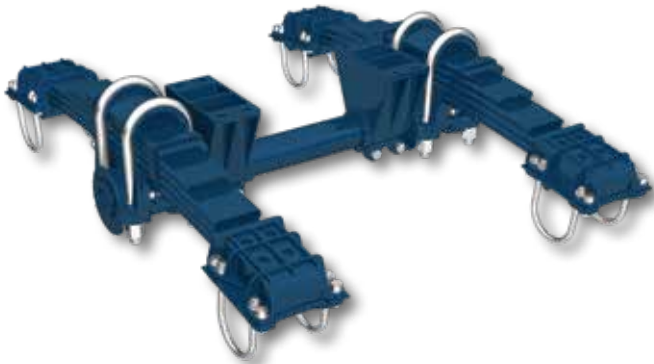

## CAPACITY TYPE

CAPACITY	<input type="checkbox"/> 50K LBS.	<input type="checkbox"/> 50K LBS. PARABOLIC	<input type="checkbox"/> 60K LBS.	<input type="checkbox"/> 70K LBS.		
AXLE SEAT DIAMETER	<input type="checkbox"/> 5.00"	<input type="checkbox"/> 5.00"	<input type="checkbox"/> 5.00"	<input type="checkbox"/> 5.75" (KIT ONLY)	<input type="checkbox"/> 5.00"	<input type="checkbox"/> 5.75" (KIT ONLY)

## CONFIGURATION TYPE

OVERSLUNG TRUNNION  
(SPRING ABOVE TRUNNION TUBE)

UNDERSLUNG TRUNNION  
(TRUNNION TUBE ABOVE SPRING)

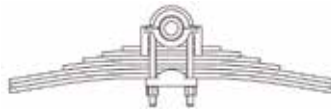
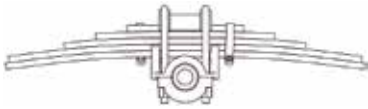

## AXLE SEAT TYPE

OVERSLUNG AXLE

SLIDE PAD OVERSLUNG AXLE

UNDERSLUNG AXLE



## MOUNTING STYLE OPTION

STRADDLE MOUNT

TRUNNION MOUNT

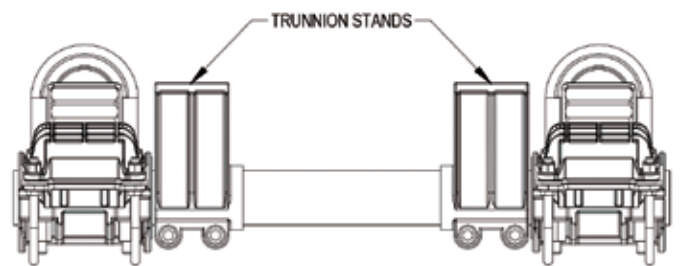
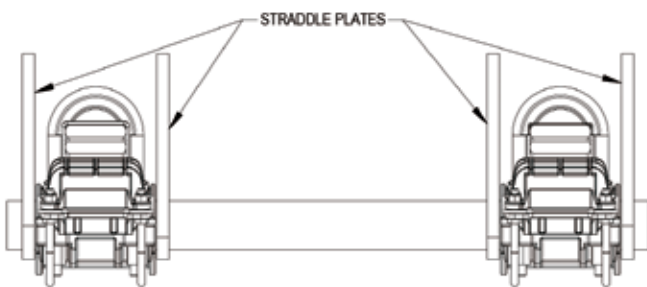

STRADDLE PLATES: HEIGHT\* \_\_\_\_\_

INNER PLATE: WIDTH \_\_\_\_\_

OUTER PLATE: WIDTH \_\_\_\_\_

TOP PLATE:  NO  YES\*\*

\* 1.50" OF CLEARANCE IS NEEDED BETWEEN TOP OF TRUNNION U-BOLTS TO BOTTOM OF FRAME

\*\* IF YES, PLEASE CONTACT SALES FOR MORE INFORMATION

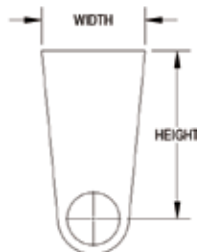

TRUNNION STAND HEIGHT:

LESS TRUNNION STANDS

2.50"

4.50"

6.50"

8.50"

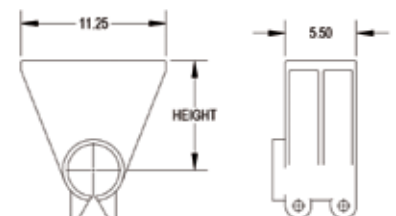

## STRADDLE MOUNT SPRING CENTERS

37.00" (71.50 TRACK)  43.00" (77.50 TRACK)  OTHER \_\_\_\_\_

## TRUNNION MOUNT SPRING CENTERS

38.00" (71.50 TRACK)  44.00" (77.50 TRACK)  OTHER \_\_\_\_\_

# SP ORDERING GUIDE

**TABLE 1: OVERSLUNG AXLE SPECIFICATIONS AND AXLE HEIGHTS**

MODEL	CAPACITY	NO. OF SPRING LEAVES	NOMINAL AXLE SPACING		STANDARD TRUNNION AXLE HEIGHT		REVERSE TRUNNION AXLE HEIGHT	
			UNLOADED	LOADED	UNLOADED	LOADED	UNLOADED	LOADED
PAR50	50,000	3	50.50	51.00	1.88	0.50	12.13	10.69
HD60	60,000	9	53.00	54.00	1.94	0.38	15.38	13.75
HD70	70,000	10	53.00	54.00	1.94	0.38	16.19	14.56
HD80	80,000	12	53.00	54.00	1.94	0.38	17.75	16.13

AXLE SEAT TYPE: OVERSLUNG AXLE OR SLIDE PAD OVERSLUNG AXLE  
CONFIGURATION STYLE: OVERSLUNG TRUNNION

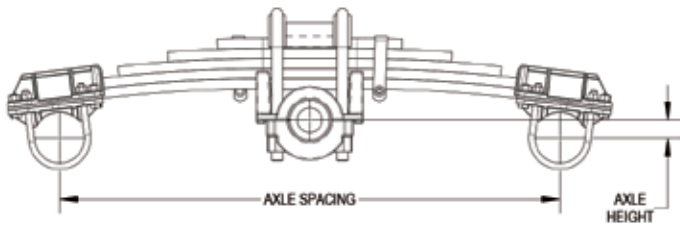

AXLE SEAT TYPE: OVERSLUNG AXLE OR SLIDE PAD OVERSLUNG AXLE  
CONFIGURATION STYLE: UNDERSLUNG TRUNNION

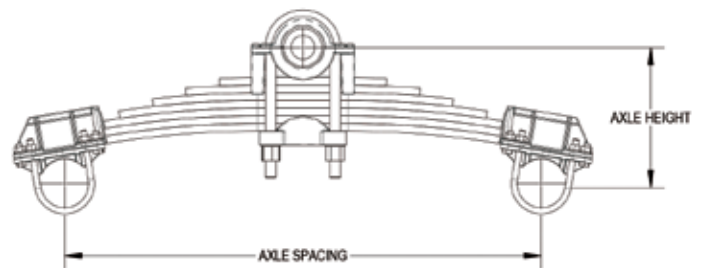

**TABLE 2: UNDERSLUNG AXLE SPECIFICATIONS AND AXLE HEIGHTS**

MODEL	CAPACITY	NO. OF SPRING LEAVES	NOMINAL AXLE SPACING		STANDARD TRUNNION AXLE HEIGHT		REVERSE TRUNNION AXLE HEIGHT	
			UNLOADED	LOADED	UNLOADED	LOADED	UNLOADED	LOADED
PAR50	50,000	3	53.00	52.50	-7.38	-8.88	2.88	1.44
HD60	60,000	9	55.50	54.00	-7.38	-9.00	6.00	4.38
HD70	70,000	10	55.50	54.00	-7.38	-9.00	6.88	5.19
HD80	80,000	12	55.50	54.00	-7.38	-9.00	8.44	6.75

AXLE SEAT TYPE: UNDERSLUNG AXLE  
CONFIGURATION STYLE: OVERSLUNG TRUNNION

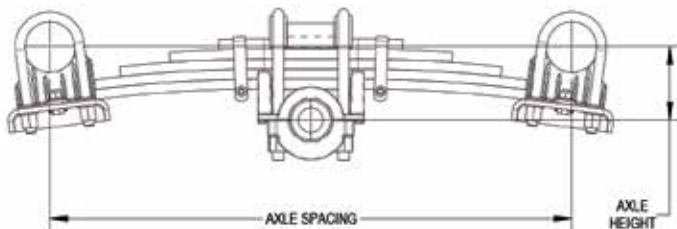

AXLE SEAT TYPE: UNDERSLUNG AXLE  
CONFIGURATION STYLE: UNDERSLUNG TRUNNION

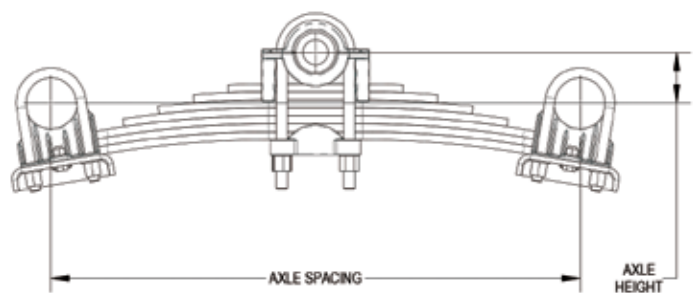

# SP ORDERING GUIDE

## AXLE ROTATION

### FRONT AXLE

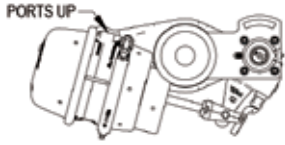
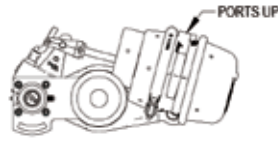
 BR1 (STANDARD)

 BR2

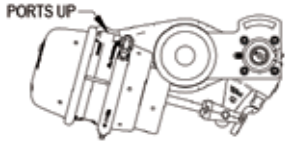
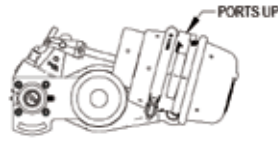
### REAR AXLE

 BR1 (STANDARD)

 BR2

## AXLE TYPE

 STRAIGHT



## AXLE TRACK

 71.50" (96" WIDE TRAILER)

 77.50" (102" WIDE TRAILER)

 OTHER: \_\_\_\_\_

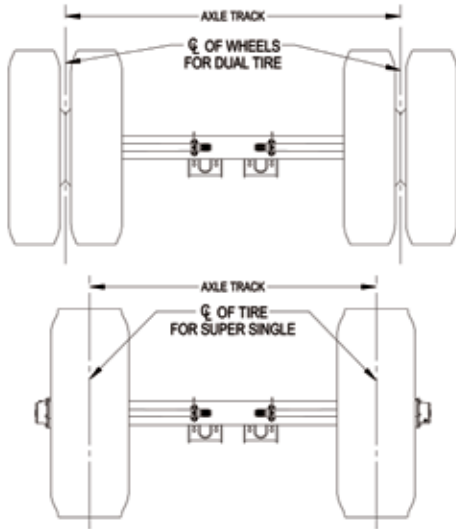
### AXLE TRACK FROM 60" TO 120" IN 1/2" INCREMENTS

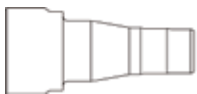
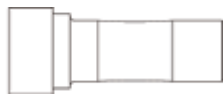

## SPINDLE TYPE

 HN (TAPERED)

 HP (PARALLEL)

## AXLE WALL

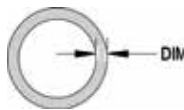
 5/8" (NOMINAL)

 3/4"

## AXLE CAPACITY

SPINDLE TYPE	SUSPENSION	AXLE DIAMETER	5/8" NOM. WALL	3/4" WALL
HN	MECHANICAL SPRING	5" ROUND	UP TO 25,000	UP TO 27,000
HP	MECHANICAL SPRING	5" ROUND	UP TO 25,000	UP TO 27,000

## BRAKE CHAMBER BRACKET

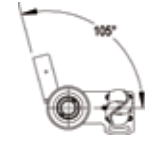
 STANDARD

## DRUM BRAKE TYPE

BRAKE LINING

 H20

 H23

BRAKE SIZE

 16.50"×7.00"

 16.50"×8.63"

 16.50"×7.00"

 16.50"×8.63"

BRAKE MODEL

 STANDARD  
 HXS\*

HXS\*

 STANDARD  
 HXS\*

HXS\*

CHAMBER STROKE

 2.5" STROKE

 2.5" STROKE

 3.0" STROKE

 3.0" STROKE

PARKING CHAMBERS

 TYPE 30/30  
 NONE

 TYPE 30/30  
 NONE

 TYPE 30/30  
 NONE

 TYPE 30/30  
 NONE

SERVICE CHAMBERS

 TYPE 30  
 NONE

 TYPE 30  
 NONE

BRAKE CHAMBER VENDOR\*\*

 STANDARD

 DI-PRO

 BENDIX

 HALDEX

\* HXS - EXTENDED LIFE SHOES

\*\* OPTION OTHER THAN STANDARD IS CONSIDERED A PREMIUM

## S-CAM TYPE

S-CAM LENGTH

 23.75" (STANDARD)

 26.50" (LONG CAMS)

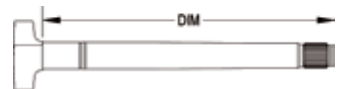
 OTHER (6.63" MIN - 35.5" MAX): \_\_\_\_\_

CAM TUBE

 NONE (STANDARD)

 YES

## SLACK ADJUSTER TYPE

SLACK ADJUSTER LENGTH

 6.0" (STANDARD)  
 (LONG STROKE CHAMBER RECOMMENDED)

 5.5"

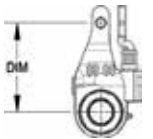
 NONE

## DUST SHIELD

 NONE (STANDARD)

 YES

## ABS SENSOR

FRONT AXLE

 NONE

 YES

REAR AXLE\*

 NONE

 YES

\* RECOMMENDED TO BE INSTALLED ON REAR AXLE

 NOTES: \_\_\_\_\_  
 \_\_\_\_\_  
 \_\_\_\_\_  
 \_\_\_\_\_

# SP ORDERING GUIDE

## DRUM BRAKE WHEEL-END

	<input type="checkbox"/> STANDARD	<input type="checkbox"/> CONMET PRESET PLUS	<input type="checkbox"/> LESS WHEEL-END
HUB MATERIAL	<input type="checkbox"/> DUCTILE IRON (STANDARD) <input type="checkbox"/> ALUMINUM <input type="checkbox"/> DURA-LIGHT HUB	<input type="checkbox"/> DUCTILE IRON (STANDARD) <input type="checkbox"/> ALUMINUM	N/A
DRUM MATERIAL	<input type="checkbox"/> DUCTILE IRON (STANDARD) <input type="checkbox"/> LIGHT WEIGHT	<input type="checkbox"/> DUCTILE IRON (STANDARD) <input type="checkbox"/> LIGHT WEIGHT	N/A
HUB STYLE	HUB PILOT	HUB PILOT	N/A
NUMBER OF STUDS - BOLT CIRCLE DIA.	<input type="checkbox"/> 10 - 11.25" (STANDARD) <input type="checkbox"/> 10 - 335MM <input type="checkbox"/> 8 - 275MM (12.25"×7.50")	<input type="checkbox"/> 10 - 11.25" (STANDARD)	N/A
STUD LENGTH	<input type="checkbox"/> LONG STUD <input type="checkbox"/> SHORT STUD	<input type="checkbox"/> LONG STUD <input type="checkbox"/> SHORT STUD	N/A
LUBE TYPE	<input type="checkbox"/> SAE 80W/90 (STANDARD) <input type="checkbox"/> SYNTHETIC 75W/90 <input type="checkbox"/> SEMI-FLUID GREASE	<input type="checkbox"/> SAE 80W/90 (STANDARD) <input type="checkbox"/> SYNTHETIC 75W/90 <input type="checkbox"/> SEMI-FLUID GREASE	N/A
LUBE INSTALLED	<input type="checkbox"/> YES (STANDARD) <input type="checkbox"/> NO	<input type="checkbox"/> YES (STANDARD)	N/A
SPINDLE NUT	<input type="checkbox"/> 3-PIECE (STANDARD) <input type="checkbox"/> PRO-TORQUE NUT	(CONMET INCLUDED)	N/A
ABS TONE RING	INSTALLED	INSTALLED	N/A

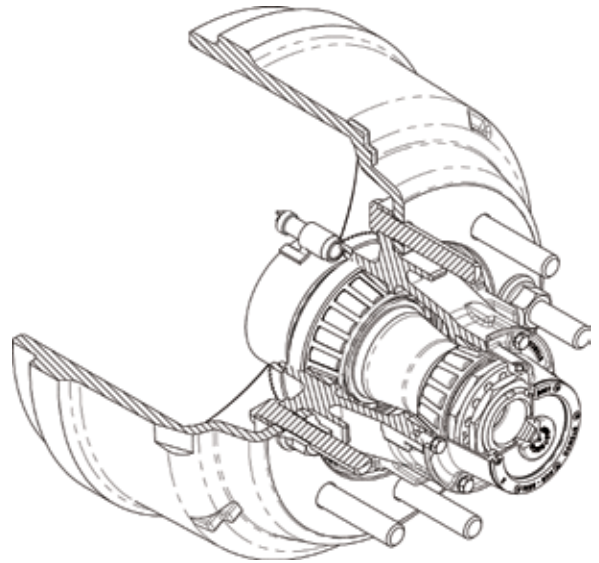

## AIR DISC BRAKE OPTIONS

### AIR DISC AXLE ROTATION

#### FRONT AXLE

BRA (STANDARD)

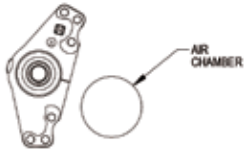

BRB



#### REAR AXLE

BRA (STANDARD)

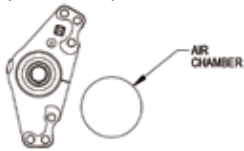

BRB



### AIR DISC BRAKE

AXLE VENDOR	<input type="checkbox"/> WABCO PAN22	<input type="checkbox"/> KNORR / BENDIX ADB22X-LT
PAD / LINING	WABCO 230	BX276
ABS TONE RING DUST SHIELD	REQUIRED	REQUIRED
ROTOR BRAND / MATERIAL	430MM CAST IRON	430MM CAST IRON
PARKING CHAMBER	<input type="checkbox"/> TYPE 20/24	<input type="checkbox"/> TYPE 18/24
SERVICE CHAMBER	<input type="checkbox"/> TYPE 20	<input type="checkbox"/> TYPE 18

NOTES: \_\_\_\_\_

\_\_\_\_\_

\_\_\_\_\_

\_\_\_\_\_

\_\_\_\_\_

### AIR DISC BRAKE WHEEL-END

	<input type="checkbox"/> STANDARD	<input type="checkbox"/> CONMET PRESET
HUB MATERIAL	DUCTILE IRON	ALUMINUM
NUMBER OF STUDS - BOLT CIRCLE DIA.	10 - 11.25"	10 - 11.25"
STUD LENGTH	<input type="checkbox"/> LONG STUD <input type="checkbox"/> SHORT STUD	<input type="checkbox"/> LONG STUD <input type="checkbox"/> SHORT STUD
LUBE TYPE	<input type="checkbox"/> SAE 80W/90 (STANDARD) <input type="checkbox"/> SEMI-FLUID GREASE	<input type="checkbox"/> SAE 80W/90 (STANDARD) <input type="checkbox"/> SEMI-FLUID GREASE
LUBE INSTALLED	<input type="checkbox"/> YES (STANDARD) <input type="checkbox"/> NO	INSTALLED
SPINDLE NUT	3-PIECE (SET SCREW)	(CONMET INCLUDED)
ABS TONE RING	INSTALLED	(CONMET INCLUDED)

### ABS SENSOR

FRONT AXLE	<input type="checkbox"/> NONE	<input type="checkbox"/> YES
REAR AXLE*	<input type="checkbox"/> NONE	<input type="checkbox"/> YES

\*RECOMMENDED TO BE INSTALLED ON REAR AXLE

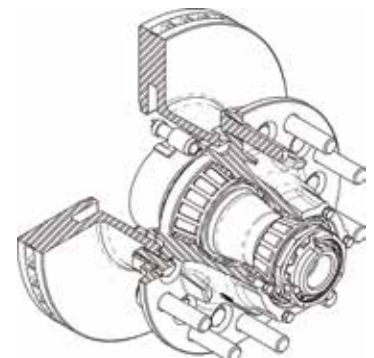

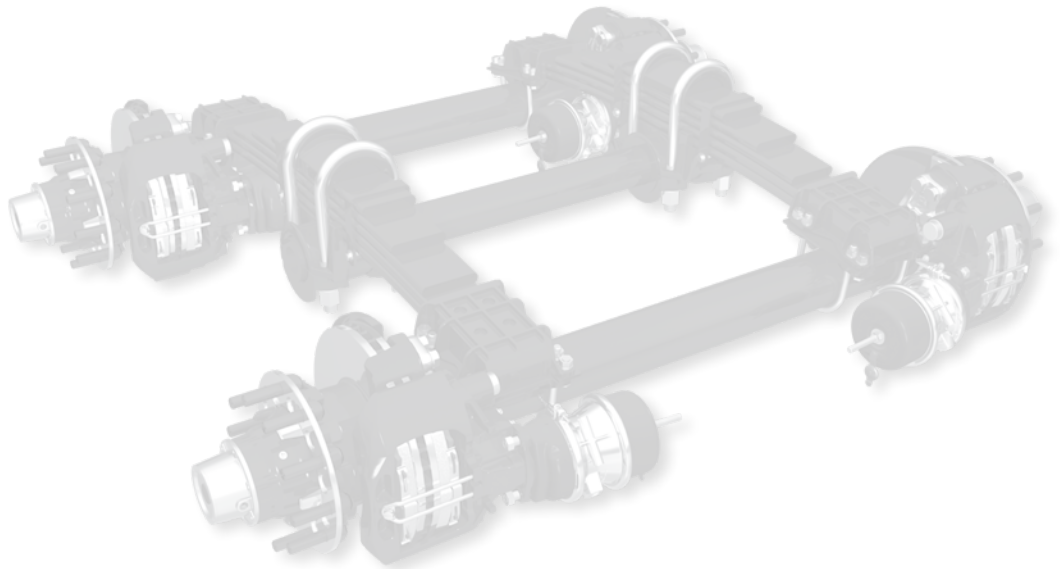
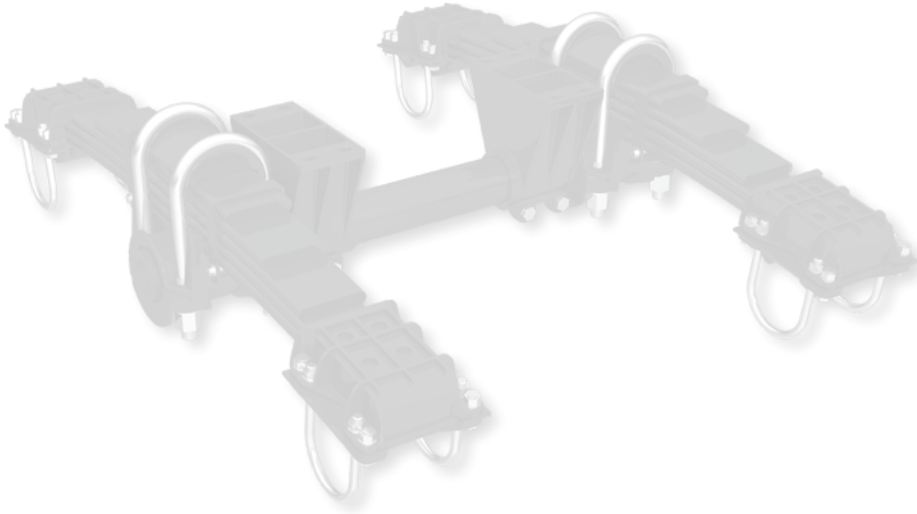

Contact Watson & Chalin at 972.547.6020 for additional information.



**W&C**  
725 E. University Drive, McKinney, Texas 75069  
972.547.6020 • 800.445.0736 • Fax 972.542.0097  
[www.wcsuspensions-intl.com](http://www.wcsuspensions-intl.com)



W&C187 Rev C 11-22

© 2016 - 2022 Watson & Chalin Manufacturing Inc. All Rights Reserved. All trademarks shown are owned by Watson & Chalin Manufacturing Inc., or one of its affiliates, in one or more countries. Information contained in this literature was accurate at the time of publication. Product changes may have been made after the copyright date that are not reflected.

Printed in United States of America