

REV.	DESCRIPTION	ECN	DATE	BY
A	NEW DRAWING	C-4261	10/23/2006	TEG
B	CHNGD QTY OF ITEM #1 FROM 4 TO 8; CHNGD QTY OF #2 FROM 8 TO 16; RMVD #4(PART NO. 17057); #5 WAS 19040-075F	C-4930	10/11/2007	HDH
C	ADDED BUSHING GREASE DETAIL TO DRAWING	C-5340	04/17/2008	DRB
D	ADDED TORQUE SPECS TO DRAWING	C-5340	05/12/2008	DRB
E	ADDED ISO DETAIL; UPDATED CHARTS	C-5561	06/24/2008	TLK



SERVICE REPAIR KIT SRK1190-1			SL1190 BUSHING REPAIR KIT	
ITEM	PART NO.	QTY	DESCRIPTION	
1	10033	8	CAPSCREW .75 X 5.00 UNF GR8	
2	10043	16	WASHER FLAT .75 HARDENED	
3	12927-03	8	WASHER FLAT .78X3.25X.25	
4	-	-	-	
5	10028	8	NUT LOCK .75 UNF GR8	
6	19204	16	BUSHING POLY FLANGE SL1190	
7	91031	8	BUSHING SLEEVE SL1190	

Torque Requirement Procedures

All fasteners should be re-torqued according to the following schedule.

- after 5 days
- after 30 days
- after 60 days
- every 6 months thereafter

Capscrew/Bolt (Grade 8 UNF) TORQUE Requirements

Capscrew/Bolt Size	3/8"	1/2"	5/8"	3/4"	3/4" (Stabilizer Shock Stud)	7/8"	1"	1 1/8"
Torque minimum ft./lbs.	25	50	150	300	200	500	700	900
Torque maximum ft./lbs.	35	75	200	350	250	550	800	1000

NOTE

Torque Values do not apply to air springs or lower grade fasteners.

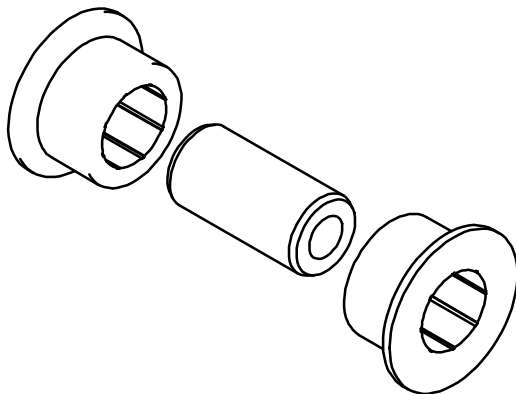

COAT BOTH INNER AND OUTER DIAMETER OF POLY BUSHING SURFACES WITH LUBRICANT-CURRENT SPEC. CHEVRON ULTI-PLEX EP-NLGI2

MATERIAL INFO:	DEPTS AFFECTED	TOLERANCES (EXCEPT AS NOTED)	DESCRIPTION: SRK KIT SL1190 BUSHING	
STEEL PART NO.	-	DECIMAL ± .03	PREVIOUS ASSY:	-
MATERIAL:	-	FRACTIONAL ± 1/32	SUSPENSION MODEL:	-
WEIGHT:	-	ANGULAR ± 0.5°	SCALE:	1:1
			DATE:	10/23/06
			DRAWN BY:	TEG
			SIZE:	A
			DRAWING NO:	SRK1190-1

