

2

1

REV.	DESCRIPTION	ECN	DATE	BY
A	NEW DRAWING	300009	01/07/2015	CRM

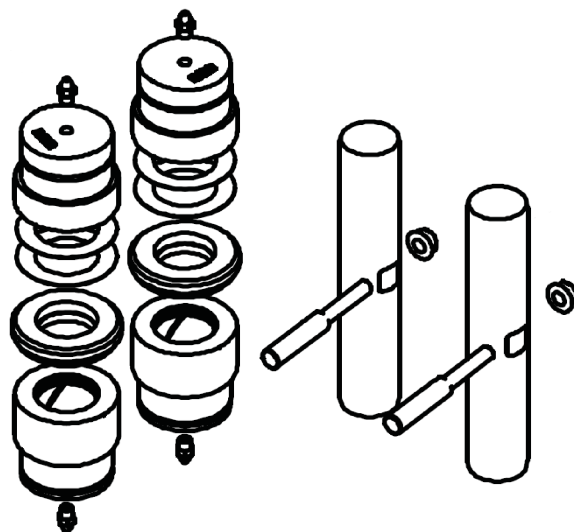

SAME AS HENDRICKSON PART NUMBER R-010300.

NOTES:

- FOR SL1093, SL1195, AND SL2065.

SPECIAL CHARACTERISTICS SYMBOL LEGEND
>X.XX< W/C CRITICAL DIM
(X.XX) FOR REFERENCE ONLY
**X.XX DESIGNATES A ± .125 TOL.
*X.XX DESIGNATES A KEY CUSTOMER CHARACTERISTIC

UNLESS OTHERWISE NOTED TOLERANCE ARE: X: +/- .1 XX: +/- .06 XXX: +/- .030 ANGULAR: +/- .5° TORQUE: +10%/-0%
THIRD ANGLE PROJECTION DIMENSIONS ADHERE TO ASME Y14.5-2009

WEIGHT:	-
MODEL	SL
DRAWN BY	CRM
DATE	01/07/2015

WATSON & CHALIN MFG INC 725 EAST UNIVERSITY DRIVE MCKINNEY TEXAS 75069			
TITLE KINGPIN BUSHING KIT W/KINGPIN			
SHEET	SCALE	SIZE	DWG NO.
1 OF 1	1:8	A	R-010300

ALL WATSON AND CHALIN INTELLECTUAL PROPERTY & PROPRIETARY INFORMATION IS PROTECTED BY U.S. & INTERNATIONAL COPYRIGHT LAWS. ANY USE WITHOUT THE EXPRESS WRITTEN PERMISSION OF WATSON AND CHALIN PROHIBITED.

2

1